

Quilting

Quilting, whether by hand or machine, enhances the pieced or appliquéd design of the quilt. You may choose to quilt in-the-ditch, echo the pieced or appliquéd motifs, use patterns from quilting design books and stencils, or do your own free-motion quilting. Remember to check your batting manufacturer's recommendations for how close the quilting lines must be.

Binding

Trim excess batting and backing from the quilt, even with the edges of the quilt top.

DOUBLE-FOLD STRAIGHT-GRAIN BINDING

For a $\frac{1}{4}$ " finished binding, cut the binding strips 2" wide and piece them together with diagonal seams to make a continuous binding strip. Trim the seam allowance to $\frac{1}{4}$ ". Press the seams open.

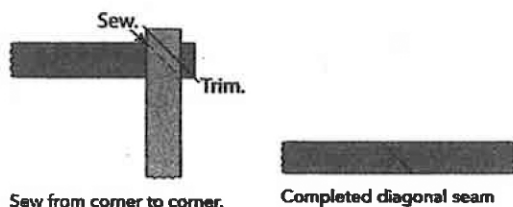

Press the entire strip in half lengthwise with wrong sides together. With raw edges even, pin the binding to the front edge of the quilt a few inches away from a corner, and leave the first few inches of the binding unattached. Start sewing (through both layers of binding, the quilt top, the batting, and the backing), using a $\frac{1}{4}$ " seam allowance.

Stop $\frac{1}{4}$ " away from the first corner you come to (see Step 1), and backstitch 1 stitch. Lift the presser foot and needle. Rotate the quilt a quarter turn. Fold the binding at a right angle

so it extends straight above the quilt and the fold forms a 45° angle in the corner (see Step 2). Then bring the binding strip down even with the edge of the quilt (see Step 3). Begin sewing at the folded edge. Repeat in the same manner at all corners.

Continue stitching until you are back near the beginning of the binding strip. See Finishing the

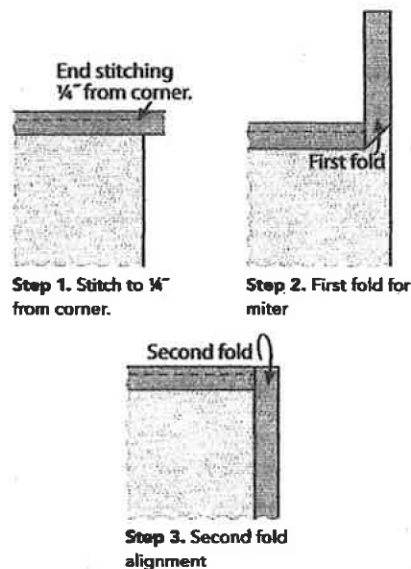

Binding Ends (page 137) for tips on finishing and hiding the raw edges of the ends of the binding.

CONTINUOUS BIAS BINDING

A continuous bias involves using a square sliced in half diagonally and then sewing the triangles together so that you continuously cut marked strips to make continuous bias binding. The same instructions can be used to cut bias for piping. Cut the fabric for the bias binding or piping so it is a square. For example, if the yardage is $\frac{1}{2}$ yard, cut an 18" x 18" square. Cut the square in half diagonally, creating 2 triangles.

Sew these triangles together as shown, using a $\frac{1}{4}$ " seam allowance. Press the seam open.

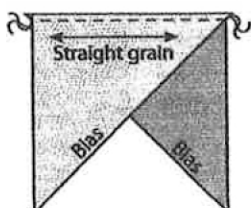

Sew triangles together.

Using a ruler, mark the parallelogram created by the two triangles with lines spaced the width you need to cut your bias. Cut about 5" along the first line.

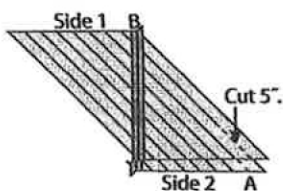

Mark lines and begin to cut.

Join Side 1 and Side 2 to form a tube. The raw edge at point A will align with the raw edge at B. This will allow the first line to be offset by the width of a strip. Pin the raw edges right sides together, making sure that the drawn lines match. Sew with a $\frac{1}{4}$ " seam allowance. Press the seam open. Cut along the drawn lines, creating a single continuous strip.



Press the entire strip in half lengthwise with wrong sides together. Place binding on the quilt as described in Double-Fold Straight-Grain Binding (page 136).

FINISHING THE BINDING ENDS

METHOD 1

After stitching around the quilt, fold under the beginning tail of the binding strip $\frac{1}{4}$ " so that the raw edge will be inside the binding after it is turned to the back of the quilt. Place the end tail of the binding strip over the beginning folded end. Continue to attach the binding and stitch slightly beyond the starting stitches. Trim the excess binding. Fold the

binding over the raw edges to the quilt back and hand stitch, mitering the corners.

METHOD 2

See C&T Publishing's blog entry at ctpubblog.com, search for "invisible seam," then scroll down to "Quilting Tips: Completing a Binding with an Invisible Seam."

Fold the ending tail of the binding back on itself where it meets the beginning binding tail. From the fold, measure and mark the cut width of your binding strip. Cut the ending width of your binding strip. Cut the ending binding tail to this measurement. For example, if your binding is cut $2\frac{1}{8}$ " wide, measure from the fold on the ending tail of the binding $2\frac{1}{8}$ " and cut the binding tail to this length.

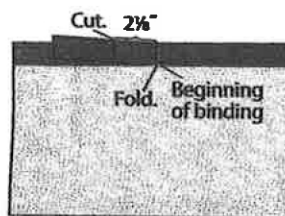

Cut binding tail.

Open both tails. Place a tail on top of the other tail at right angles, right sides together. Mark a diagonal line from corner to corner and stitch on the line. Check that you've done it correctly and that the binding fits the quilt; then trim the seam allowance to $\frac{1}{4}$ ". Press open.

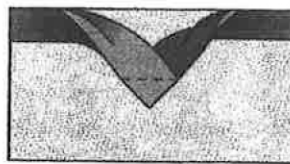

Stitch ends of binding diagonally.

Refold the binding and stitch this binding section in place on the quilt. Fold the binding over the raw edges to the quilt back and hand stitch.